

MONTHLY BULLETIN

ATTENTION: ALL FACILITIES

**UPDATES OCCURRING WITHIN THE CIS THE
WEEK OF - MAY 28, 2018**

The following solution areas have updates:

Provincial Drugs & Therapeutics (PD &T) - Page 2

Order Sets - Page 2

Physician & Nurse Practitioner (NP) - Page 3

PowerChart, FirstNet & SurgiNet - Pages 3 - 4

***Please note there are two attachments to this bulletin**

UPCOMING EVENTS

There are no upcoming events in CIS.

Provincial Drugs & Therapeutics (PD&T):

New Inhalation Devices

Reference texts have been added to inhaler orderables in PowerChart to provide quick access to patient-friendly teaching instructions. **Please see further details in the attached notice from the Medication Management Quality Improvement Team.**

Order Set Updates:

The following new Order Sets or changes were approved at PD&T this month:

1. Alteplase and Dornase for Pleural Effusion is LIVE
2. Medical Directive Suspect Stroke is LIVE
3. Insulin Correction doses for Frail Elderly **(see attached memo)**
4. ODT (oral dissolve tablet) ondansetron removed from all adult Powerplans. Oral tablet will be the only option.
5. NEW! ED Sexual Exposure Order Set

Physician & NP Updates:

Message Center Default display change - As per the direction of the PMAC, the default message center filter shall display all content regardless of time frame. This is a change from the previous 90 day default.

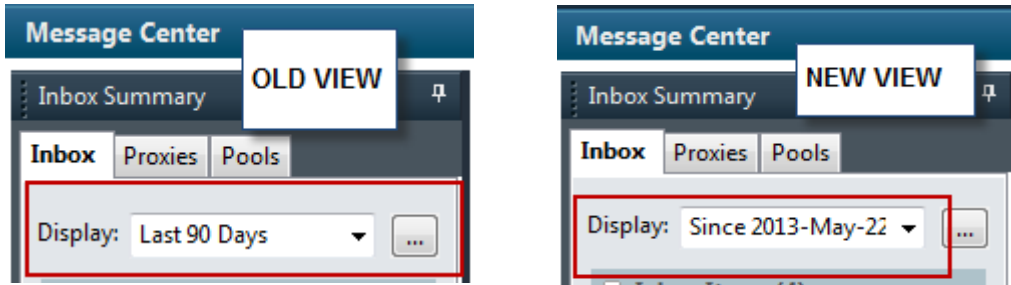

PowerChart, FirstNet & SurgiNet updates:

Update to Vital Sign Form - Addition of Ankle Brachial Index Measurement - This is accessed by a link on the vital sign powerform

The screenshot shows the 'Ankle Brachial Index' form in PowerChart. The form includes fields for 'Ankle Pressure' and 'Brachial Pressure', both with units of 'mmHg'. There is also a field for 'Ankle/Brachial Index'. To the right of these fields is a table of interpretation ranges.

Range	Interpretation
Above 1.03	Noncompressible
1.00 to 1.29	Normal
0.91 to 0.99	Borderline
0.41 to 0.90	Mild to Moderate P.A.D.
0.00 to 0.40	Severe P.A.D.

New Order/Task - New order/task for "Administer Hepatitis B Immune Globulin", to be added to the NEONATAL Newborn Hepatitis B Orders/ED Sexual Exposure powerplans. This will give nursing an administration task.

PowerChart, FirstNet & SurgiNet updates (continued):

Ordering Physician Window when completing prescription in BPMH - The Ordering Physician window will pop up when completing prescriptions during the documentation of BPMH. This only happens when the ordering physician is no longer active in the system. The workaround is to enter **Unknown Physician** as the ordering physician.

Ghosting of charts/Slow loading PAL/Tracking List/Case Selection Tool - Since the code upgrade in April, staff have been reporting issues with ghosting of charts (slow to close and layered over the PAL/Tracking List/Case Selection Tab) as well as a cascading effect of loading the PAL/Tracking List/Case Selection tabs. We are working with Cerner to resolve this issue.

Closing tabs on the Summary Mpages (Handoff, Physician Summary, Pediatrician Summary etc) - The X next to the heading enables the user to remove the tab from view

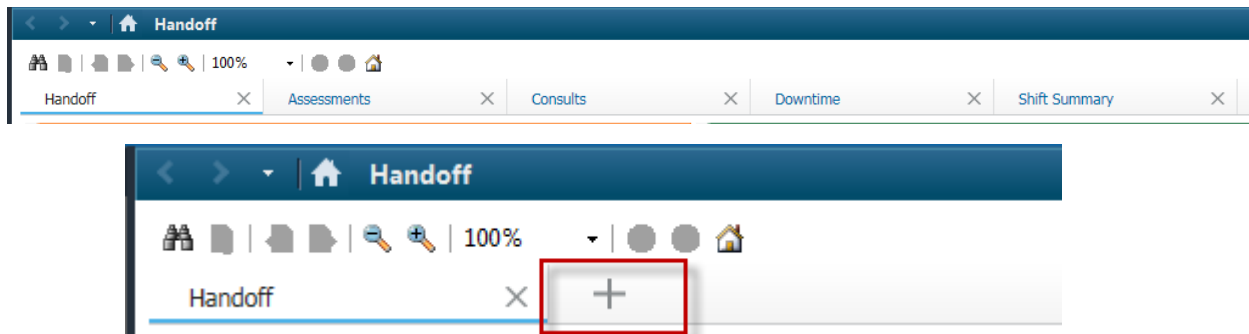

To return the tab, click on the + symbol and then the Tab you want to add back

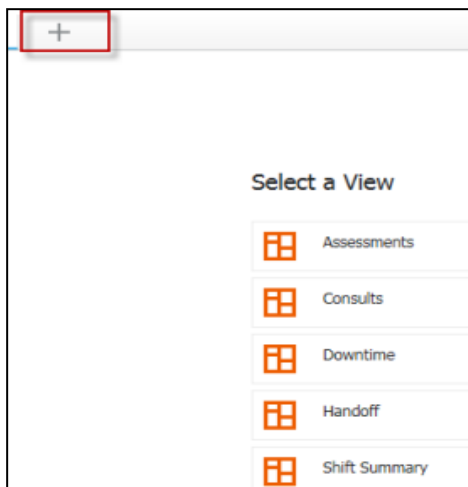

If the Mpage doesn't have multiple tabs, this is not available functionality.