

# Health PEI

## ***SAFER PRACTICE NOTICE***

Safe Use of Bathing Equipment  
DATE: May 2023

### **Issue:**

An incident was reported in the Provincial Safety Management System (PSMS) where a resident slid down in a tub during bathing. A staff member was injured while physically supporting the resident to prevent them from sliding further down in the tub and to protect them from injury.

This incident highlighted the potential risks associated with the use of bathing equipment. Multiple factors contributed to the incident including:

- The safety belt was missing a black locking clip that is essential to stop the safety belt from sliding
- The equipment used was not appropriate to the resident's abilities
- The footboard to help support feet and prevent residents from sliding was not used.
- The emergency assistance call bell cord (red cord) in the tub room was located too far away from the tub for the staff member to reach during the incident
- The appropriate bathing equipment to be used with the resident was not charted or communicated to staff providing care to the resident.

When bathing residents it is important to remember:

- There are multiple bathing methods including showering or tub bathing
- There are multiple pieces of equipment including shower chairs/commodes which can be stationary, wheeled, tilting, and/or elevating, tubs, and tub chair lifts, tub stretcher lifts, and ceiling lifts to place the resident into a tub for bathing.
- It is important to make sure that each piece of equipment is in good working order prior to use.
- Due to the variety of equipment available for bathing, **the proper operating instructions for each piece of equipment used must be followed to promote resident and staff safety.**
- Review resident charts regularly for communication related to safe bathing methods appropriate to their physical and mental condition.

### **Recommendations:**

- Assess residents upon admission to determine an appropriate method of bathing and the bathing equipment required.
- Reassess residents as their physical or cognitive abilities change to determine if the current method of bathing is still appropriate.
- Inspect safety belts on tub chair lifts, tub stretcher lifts and mesh chairs used in tubs prior to every use to ensure they are in good working condition with no signs of fraying or damage. Do not use any frayed or damaged items.
- Inspect all safety belts on tub chair lifts, tub stretcher lifts, and mesh chairs used in tubs on a weekly basis to ensure that they are in place, undamaged, and working correctly. See the attached PDF documents for the two possible versions of the safety belt for the Alenti Tub chair, depending on the model(s) of Alenti Tub chair at your facility.

- Ensure that the method of lifting the resident into the tub is suitable for the resident, based on their physical and cognitive abilities and their care plan.
- Do not use tub chair lifts (Alenti) with residents who lack the ability to sit upright self-supporting on the side of a bed or toilet. These residents require another method of lifting them into a tub, either a stretcher tub lift, or ceiling lift and sling, based on the residents' abilities.
- Use footboards for shorter residents taking care to place the footboard in the appropriate position for the resident's height (there are 3 positions).
- All homes should ensure that call bell cords are long enough to be placed near the staff member working at the tub bathing the resident. If necessary, involve maintenance for assistance in replacing the cord with a longer one or relocating the cord.
- Ensure that the red call bell cord is placed within reaching distance prior to bathing a resident.

**For more information on this Safer Practice Notice, please contact:**

Laurissa Handren (ldhandren@ihis.org) or Sheila Gaudet (smgaudet@ihis.org), Quality Risk Consultant, Quality and Patient Safety Division

Mark Holland (miholland@ihis.org), MSIP Consultant, LTC

**Safer Practice Notices are issued by the Health PEI Quality and Patient Safety Division to communicate recommended changes as a result of events that have been reported and investigated through the Provincial Safety Management System (PSMS).**

Safer Practice Notices can be found at: <https://src.healthpei.ca/safer-practice-notice>

# Alenti

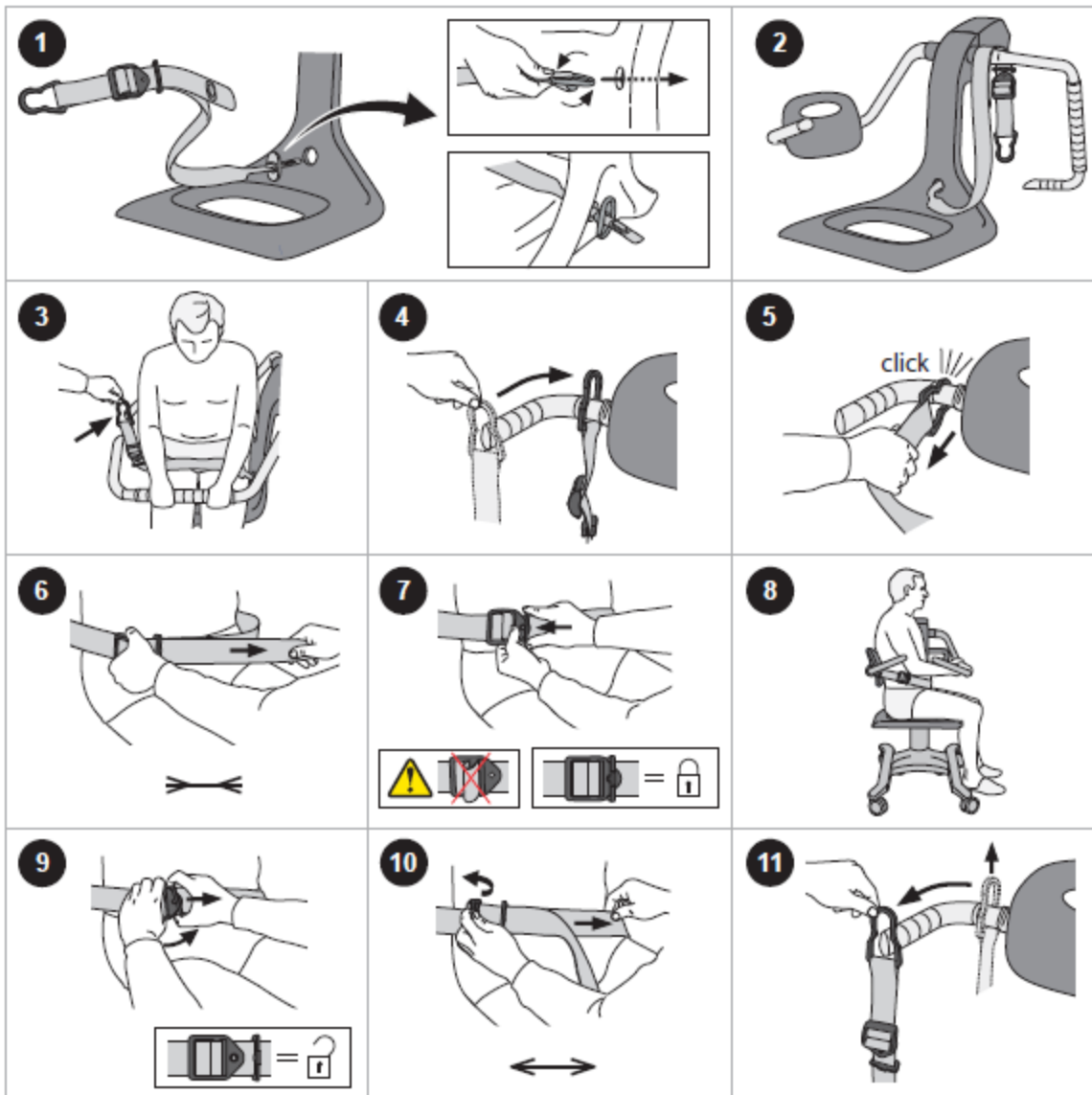

# Alenti

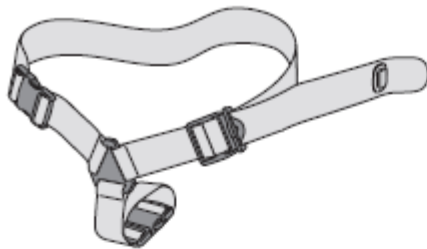

<p><b>1</b></p>	<p><b>2</b></p>	
<p><b>3</b></p>	<p><b>4</b></p>	<p><b>5</b></p>
<p><b>6</b></p>	<p><b>7</b></p>	<p><b>8</b></p>
<p><b>9</b></p>	<p><b>10</b></p>	<p><b>11</b></p>