

# How do I use my Turbuhaler®?

## Cue Words

1. **Remove** the cap and **hold upright**.
2. **Turn the base** in one direction and back.
3. **Listen** for a “click”.
4. **Breathe out**.
5. **Place between lips**.
6. **Tilt chin up** slightly.
7. **Breathe in** quickly and deeply.
8. **Hold breath** for 5-10 seconds.
9. **Breathe out**.
10. **Replace** cap.

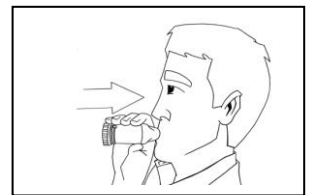
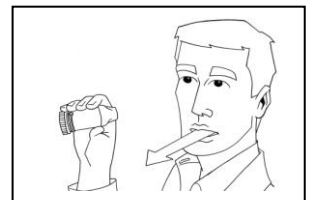
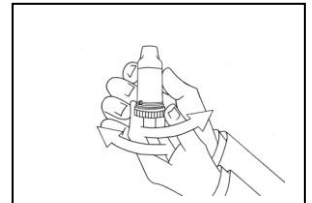
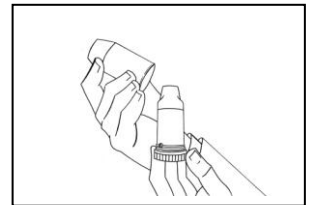

# How do I use my Turbuhaler<sup>®</sup>?

---

1. Unscrew and remove the cap.
2. Hold the Turbuhaler<sup>®</sup> in an upright position and turn the colored base as far as possible in one direction, then turn back until a “click” is heard. *Note: Do not shake or blow into the device.*
3. Breathe out away from the Turbuhaler<sup>®</sup>.
4. Place the mouthpiece between your teeth and close your lips around it.
5. Breathe in quickly and deeply through the mouth. Remove Turbuhaler<sup>®</sup> from mouth and hold breath for 10 seconds, then breathe out.
6. Repeat steps 1-5 for the prescribed number of inhalations.
7. Replace the cap.

**\* Always check the instructions included with your Turbuhaler<sup>®</sup> for directions on priming and proper use\***

## Care of a Turbuhaler<sup>®</sup>

1. Clean mouthpiece using a dry tissue or cloth, gently wiping away any particles which have collected inside the mouthpiece. Never wash the Turbuhaler<sup>®</sup>.
2. Check the number in the dose window to see how many doses are left.
3. Some Turbuhalers<sup>®</sup> may not have a window counter. When a red mark appears in the window underneath the mouthpiece, the Turbuhaler<sup>®</sup> has approximately 20 doses left. When the red mark reaches the bottom edge of the window the Turbuhaler<sup>®</sup> is empty.